

Residential Services

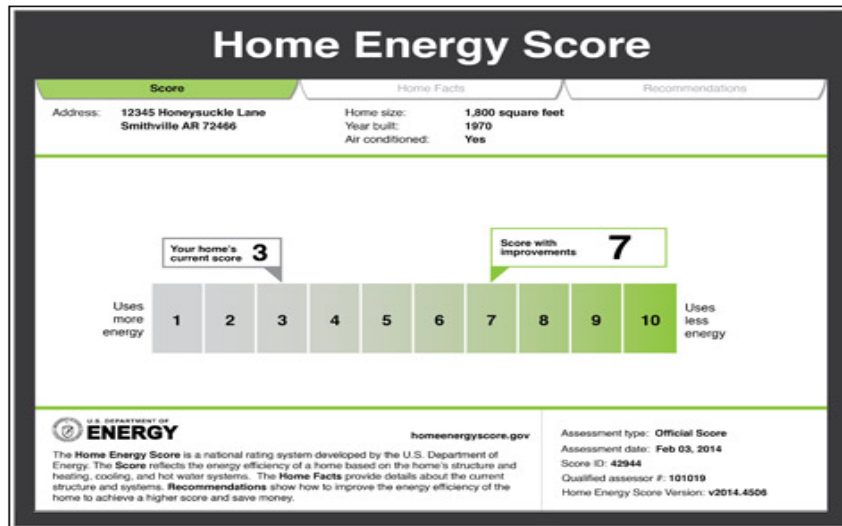

[Click image to view larger size](#)

The Home Energy Score is like a vehicle's mile-per-gallon rating, only for homes. The score, developed and administered by the U.S. Department of Energy, allows homeowners to compare the energy performance of their home to other homes nationwide. The beauty of the score is in its simplicity – on a scale of 1 to 10, a 10 shows excellent energy performance and 1 means the home needs serious energy improvements.

REScheck Energy Compliance Reports

Are you in need of a REScheck energy compliance report for your new residence, addition or alteration? We will complete the energy calculations and send you a REScheck Energy Compliance Certificate, an Inspection Checklist and an on-site posting Energy Compliance Certificate.



What we need from you:

- *Floor plan*
- *Window & door schedules (unless dimensions are indicated on floor plan)*
- *Exterior elevation views*
- *Orientation of house (north arrow)*
- *Project address*
- *Project designer name, address, and phone (can be the owner)*

Residential Pricing:



REScheck

The following REScheck energy report pricing applies to new construction, additions and alterations:

<i>Up to 500 ft²</i>	<i>- \$175.00</i>
<i>501-1000 ft²</i>	<i>- \$200.00</i>
<i>1001-1500 ft²</i>	<i>- \$225.00</i>
<i>1501-2500 ft²</i>	<i>- \$260.00</i>
<i>2501-3500 ft²</i>	<i>- \$290.00</i>
<i>3501-4500 ft²</i>	<i>- \$320.00</i>



Manual J is the ACCA (Air Conditioner Contractors of America) approved method of calculating room-by-room and whole house cooling loads.

<p>NEW INSTALL ROOM BY ROOM CALCULATION</p> <p>129.00</p>	<p>CHANGEOUT ROOM BY ROOM CALCULATION</p> <p>129.00</p>
<p>CLICK HERE TO REQUEST YOUR MANUAL J!</p>	<p>CLICK HERE TO REQUEST YOUR MANUAL J!</p>
<p>Manual J - HVAC Room By Room Load Calculation for Residential New Installation</p>	<p>Manual J - HVAC Room By Room Load Calculation for Residential Changeout Installation</p>



COMcheck Energy Compliance Reports

REScheckNow can also provide **COMcheck Compliance Certificates** for commercial projects in all states. We can provide Compliance Certificates for:

- Building Envelope
- Interior Lighting
- Exterior Lighting
- Mechanical

Select project size:

Up to 500 sq. ft. \$175.00 USD ▼

Pay Now



Commercial Energy Assessment

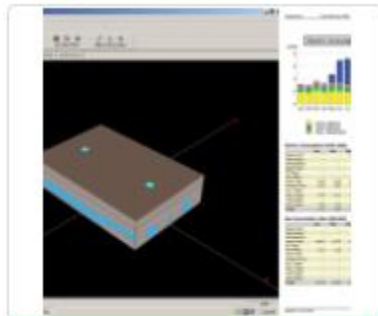

Computer Modeling

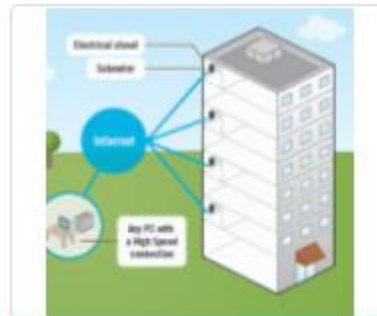

Submetering



Level 3 – Comprehensive Energy Assessment

All “Level 2” bullets, plus:

- **Software modeling** of suggestions: Financial payback, project lifecycle, expected energy savings by line item
- **Renewable Energy System Studies:** Solar Photo-Voltaics (PV), solar hot water, urban or small wind generators, geo-thermal HVAC alternatives

Prices average
\$0.25-0.55 per SF



<p>Level 1 – Energy Survey</p> <ul style="list-style-type: none"> • Utility Bill Analysis • Rate Structure / Utility Verification • Demand Response analysis • Lighting Schedule & Upgrade Suggestions • Occupant / owner behavioral energy savings training 	<p>Prices average \$0.10-0.25 per SF</p>
<p>Level 2 – Energy Assessment</p> <p>All “Level 1” bullets, plus:</p> <ul style="list-style-type: none"> • Diagnostic Testing: Ventilation rates, HVAC system, duct balancing, room by room air-flow, occupancy counts, weather studies, • Building Inspections: Durability, Water Infiltration, Air Infiltration, Insulation Levels, HVAC & Air Quality (filters), Code Violations • Environmental Testing: Water quality, air particle count, Radon testing, mold or mildew (sub-contracted), asbestos (sub-contracted), LEAD 	<p>Prices average \$0.15-0.35 per SF</p>

LEED Certification



Utility Rebate savings calculations

Utility Rebate application processing